

THIS DRAWING IS UNPUBLISHED. RELEASED FOR PUBLICATION
 © COPYRIGHT - By - ALL RIGHTS RESERVED.

LOC		DIST		REVISIONS			
P	LTR	DESCRIPTION		DATE	DWN	APVD	
FT	0	S	REVISED PER ECO-15-011608	04NOV2015	NK	MZ	

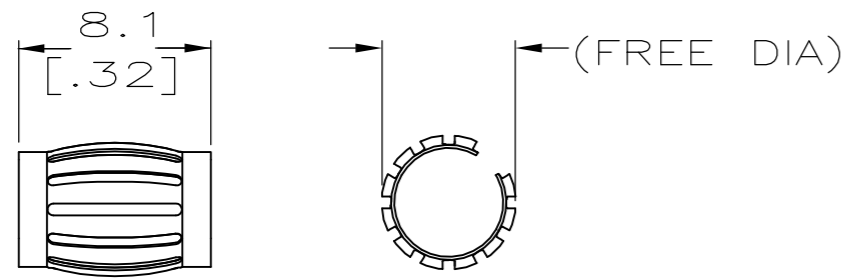

STYLE B
(MALE)

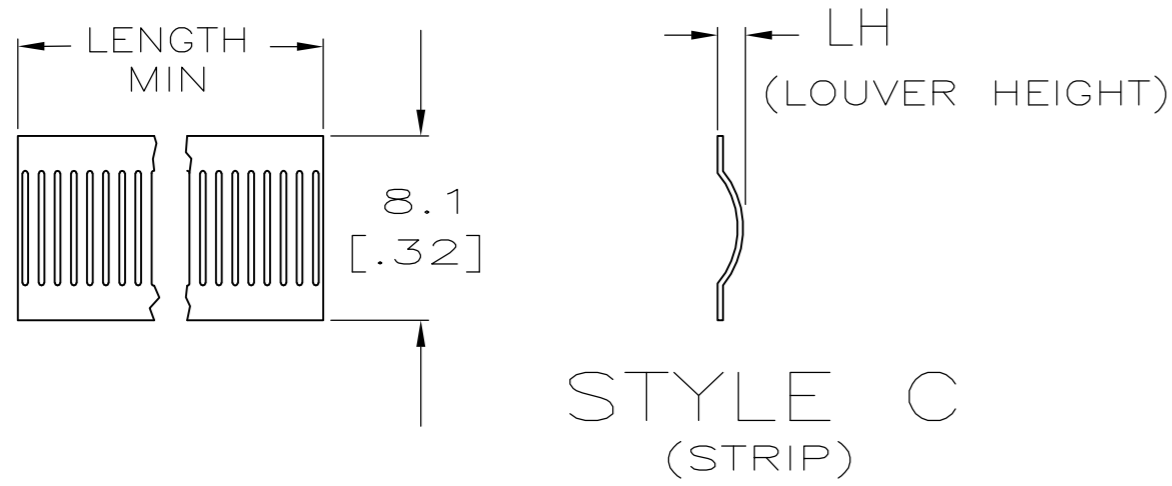

STYLE C
(STRIP)

- 1 FINISH-SILVER PLATE 200 μIN MIN THICK.
- 2 FINISH-NICKEL PLATE 40 μIN MIN THICK.
- 3 FINISH-GOLD PLATE 10 μIN MIN THICK.
- 4 FINISH-GOLD PLATE 50 μIN MIN THICK.
- 5 FINISH-CADMIUM PLATE 300 μIN MIN THICK.
- 6 FINISH-NICKEL PLATE 100 μIN MIN THICK.
- 7 FINISH-TIN PLATE 300 μIN MIN THICK.
- 8
- 9
- 10
- 11 PLATING NOTES ARE TO BE INTERPRETED AS FOLLOWS, 6-8 AS 6 OVER 8.
- 12 PRODUCT IS SOLD BY THE FOOT.
- 13 12 FOOT STRIP WOUND TO A ONE INCH INSIDE DIAMETER.
- 14 MATERIAL-BeCu (CDA172).
- 15 MATERIAL-STAINLESS STEEL.
- 16 CUT LENGTH 508.0 [20.00] APPROXIMATELY 714 LOUVERS.
- 17 BAND WIDTH .310±.005 FOR P/N 6-192042-6.
- 18 FINISH - GOLD PLATE 30μIN MIN THICK.
- 19 OVERLAPPED WITH GAP.
- 20 OBSOLETE PARTS: OBSOLETE CIS STREAMLINING PER D.RENAUD/D.SINISI
- 21 PRILIMINARY PART

QTY	DESCRIPTION	UNIT	PLATING	MAT'L THK	REF	PART NO.
20	OBSOLETE					
	[.022] -- B [.40] 14 9.5 [.375] 36 3-2 0.20 [.008]				04133	4-192042-7
	[.022] -- B [.40] 14 9.5 [.375] 36 1-2 0.15 [.006]				04054	4-192042-6
	[.022] -- B [.40] 14 9.5 [.375] 36 5 0.15 [.006]				04100	4-192042-5
	[.022] -- UNPL [.40] 14 9.5 [.375] 36 UNPL 0.15 [.006]				04156	4-192042-4
	[.022] -- UNPL [.40] 14 9.5 [.375] 36 UNPL 0.15 [.006]				04101	4-192042-3
	[.024] -- B [.30] 14 7.1 [.280] 26 3-2 0.15 [.006]				04132	4-192042-2
	[.024] -- UNPL [.30] 14 7.1 [.280] 26 UNPL 0.15 [.006]				04131	4-192042-1
	[.024] -- B [.30] 14 7.1 [.280] 26 3-2 0.15 [.006]				04048	4-192042-0
	[.024] -- UNPL [.30] 14 7.1 [.280] 26 UNPL 0.15 [.006]				04173	3-192042-9
	[.026] -- B [.23] 14 5.5 [.216] 19 6 0.20 [.008]				04043	3-192042-8
	[.026] -- B [.23] 14 5.5 [.216] 19 3-2 0.20 [.008]				04135	3-192042-7
	[.026] -- UNPL [.23] 14 5.5 [.216] 19 1-2 0.20 [.008]				04039	3-192042-6
	[.032] -- B [.20] 14 4.7 [.185] 15 3-2 0.15 [.006]				04134	3-192042-5
	[.032] -- UNPL [.20] 14 4.7 [.185] 15 UNPL 0.15 [.006]				04034	3-192042-4
	[.032] -- B [.20] 14 4.7 [.185] 15 1-2 0.15 [.006]				04033	3-192042-3
	[.032] -- UNPL [.20] 14 4.7 [.185] 15 UNPL 0.15 [.006]				04032	3-192042-2
	[.022] -- B [.17] 14 4.0 [.157] 13 4-2 0.15 [.006]				04063	3-192042-1
	[.022] -- B [.17] 14 4.0 [.157] 13 3-2 0.15 [.006]				04130	3-192042-0
	[.022] -- B [.17] 14 4.0 [.157] 13 6 0.15 [.006]				04155	2-192042-9
	[.022] -- B [.17] 14 4.0 [.157] 13 1-2 0.15 [.006]				04088	2-192042-8
	[.022] -- B [.17] 14 4.0 [.157] 13 UNPL 0.15 [.006]				04087	2-192042-7
	[.022] -- B [.15] 14 3.5 [.138] 12 3-2 0.15 [.006]				04089	2-192042-6
	[.022] -- B [.14] 14 3.0 [.118] 10 3-2 0.15 [.006]				04026	2-192042-5
	[.022] -- B [.14] 14 3.0 [.118] 10 UNPL 0.15 [.006]				04022	2-192042-4
	[.022] -- B [.13] 14 2.8 [.110] 10 3-2 0.12 [.005]				04021	2-192042-3
	[.026] -- B [.13] 14 2.5 [.098] 9 3-2 0.15 [.006]				04018	2-192042-2
	[.022] -- B [.11] 14 2.0 [.080] 6 6 0.15 [.006]				04016	2-192042-1
	[.022] -- UNPL [.11] 14 2.0 [.080] 6 3-2 0.15 [.006]				04014	1-192042-9
	[.026] -- B [.11] 14 2.0 [.080] 6 3-2 0.12 [.005]				04012	1-192042-8
	[.026] -- B [.11] 14 2.0 [.080] 6 UNPL 0.12 [.005]				04011	192042 -7
	[.020] -- B [.10] 14 2.0 [.080] 6 6 0.10 [.004]				04152	1-192042-6
	[.020] -- B [.10] 14 2.0 [.080] 6 UNPL 0.10 [.004]				04171	1-192042-5
	[.026] NOTE 13 C -- 14 -- -- 3-2 0.12 [.005]				04219	1-192042-4
	[.028] NOTE 12 C -- 14 -- -- 3-2 0.20 [.008]				04153	1-192042-3
	[.028] NOTE 12 C -- 14 -- -- 1-2 0.20 [.008]				04150	1-192042-2
	[.028] NOTE 12 C -- 14 -- -- UNPL 0.20 [.008]				04151	1-192042-1
	[.026] NOTE 12 C -- 14 -- -- 3-2 0.15 [.006]				04175	1-192042-0
	[.026] NOTE 12 C -- 14 -- -- 1-2 0.20 [.008]				04127	192042-9
	[.026] NOTE 12 C -- 14 -- -- UNPL 0.20 [.008]				04160	192042-8
	[.026] NOTE 12 C -- 14 -- -- 3-2 0.15 [.006]				04161	192042-7
	[.026] NOTE 12 C -- 14 -- -- 1-2 0.15 [.006]				04003	192042-6
	[.026] NOTE 12 C -- 14 -- -- UNPL 0.15 [.006]				04217	192042-5
	[.026] NOTE 12 C -- 14 -- -- 1-2 0.12 [.005]				04085	192042-4
	[.026] NOTE 12 C -- 14 -- -- UNPL 0.12 [.005]				04141	192042-3
	[.016] NOTE 12 C -- 15 -- -- UNPL 0.12 [.005]				--	192042-2
	[.016] NOTE 12 C -- 15 -- -- UNPL 0.12 [.005]				04181	192042-1

THIS DRAWING IS A CONTROLLED DOCUMENT.		DWN RA JAYNE 06-12-92	STE TE Connectivity	
DIMENSIONS: mm		CHK J.TURNER 07-21-93		
TOLERANCES UNLESS OTHERWISE SPECIFIED:		APVD S.SIEGRIST 07-21-93	NAME CONTACT BAND, MALE	
0 PLC ± -		PRODUCT SPEC	SIZE CAGE CODE DRAWING NO RESTRICTED TO	
1 PLC ± -		APPLICATION SPEC	A2 00779 C=192042	
2 PLC ± 0.5[.02]		WEIGHT	SCALE 1:1 SHEET 1 of 2 REV S	
3 PLC ± 0.25[.010]		CUSTOMER DRAWING		
4 PLC ± -				
ANGLES ± -				
MATERIAL				
FINISH				

